

**FOR LEASE**

**AVAILABLE: 1,055 SQUARE FEET**

**2100 N HWY 360 #1305, GRAND PRAIRIE, TX 75050**

## PROPERTY FEATURES

- ✓ Available SF: 1,055
- ✓ 100% Office Space
- ✓ Reception Area
- ✓ Open Workspace

**CORBY HODGKISS, SIOR**

Executive Vice President  
469-360-3918  
[chodgkiss@mercerc-company.com](mailto:chodgkiss@mercerc-company.com)

**NICK FULTON**

Market Director  
469-616-8783  
[nfulton@mercerc-company.com](mailto:nfulton@mercerc-company.com)

# AVAILABLE: 1,055 SQUARE FEET

2100 N HWY 360 #1305, GRAND PRAIRIE, TX 75050

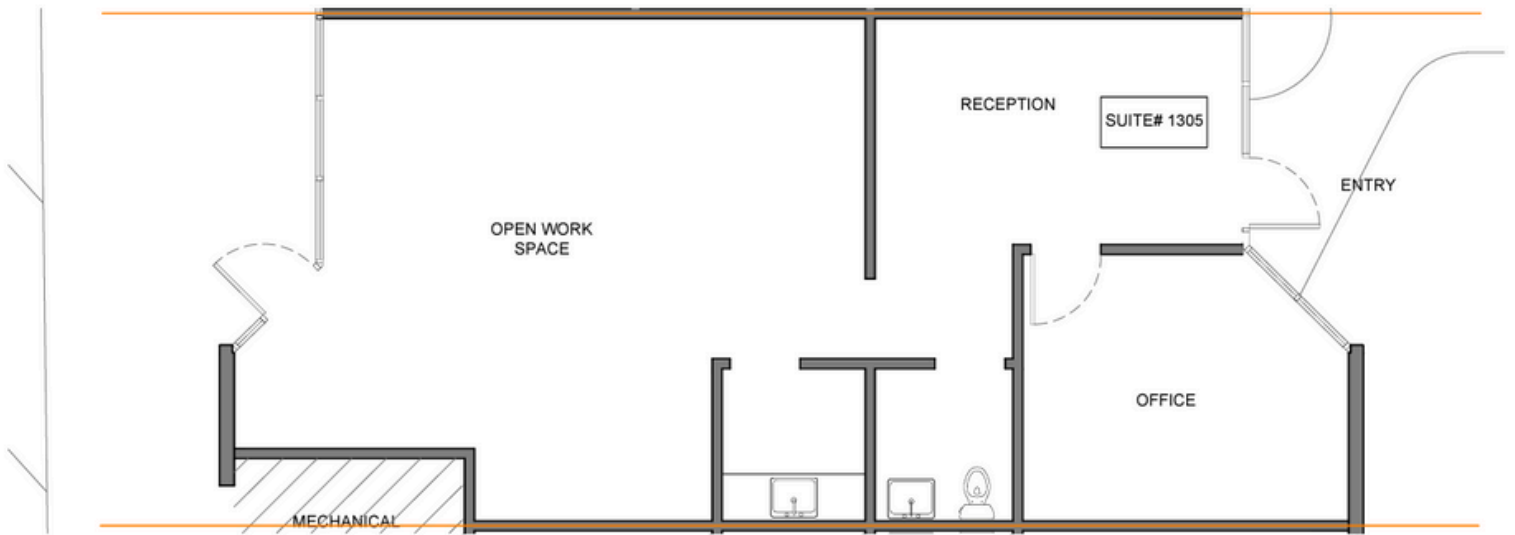

**CORBY HODGKISS, SIOR**

Executive Vice President  
469-360-3918



**NICK FULTON**

Market Director  
469-616-8783

The information contained herein has been given to us by the owner of the property or other sources we deem reliable. We have no reason to doubt its accuracy, but we do not guarantee it. All information should be verified before purchase or lease.